

4 PIN SSOP PHOTOTRANSISTOR PHOTOCOUPLER EL3H7U-G Series

Preliminary

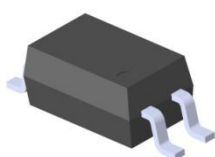

Schematic

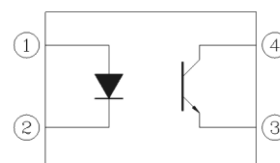

Pin Configuration

1. Anode
2. Cathode
3. Emitter
4. Collector

Features:

- Halogens free
(Br <900 ppm , Cl <900 ppm , Br+Cl < 1500 ppm)
- Current transfer ratio
(CTR: 100~560% at $I_F = 0.5\text{mA}$, $V_{CE} = 5\text{V}$)
- Operating temperature $-40^\circ\text{C} \sim 125^\circ\text{C}$
- High isolation voltage between input and output (Viso=3750 V rms)
- Compact 4 Pin SSOP with a 2.0 mm profile
- Compliance with EU REACH
- UL and cUL approved (No. E214129)
- VDE approved (No. 132249)
- SEMKO approved
- NEMKO approved
- DEMKO approved
- FIMKO approved
- CQC approved

This is a preliminary specification intended for design purposes and subject to change without prior notice.

Description

The EL3H7U-G series devices consist of an infrared emitting diode, optically coupled to a phototransistor detector encapsulated with green compound.

They are packaged in a 4-pin small outline SMD package.

Applications

- DC-DC Converters
- Programmable controllers
- Telecommunication equipments
- Signal transmission between circuits of different potentials and impedances

Absolute Maximum Ratings (T_A=25°C) *1

	Parameter	Symbol	Rating	Unit
Input	Forward current	I _F	20	mA
	Reverse voltage	V _R	5	V
	Power dissipation	P _D	40	mW
Output	Collector current	I _C	30	mA
	Collector-Emitter voltage	V _{CEO}	60	V
	Emitter-Collector voltage	V _{ECO}	5	V
	Power dissipation	P _C	150	mW
Total Power Dissipation		P _{TOT}	200	mW
Isolation Voltage*2		V _{ISO}	3750	V _{rms}
Operating temperature		T _{OPR}	-40 ~ +125	°C
Storage temperature		T _{STG}	-40 ~ +150	°C
Soldering Temperature*3		T _{SOL}	260	°C

Notes:

*1 Stresses in excess of the absolute maximum ratings can cause permanent damage to the device. Functional operation of the device is not implied at these or any other conditions in excess of those given in the operational sections of this document. Exposure to absolute maximum ratings for extended periods of the time can adversely affect reliability. The absolute maximum Ratings are stress only T_A=25°C unless otherwise specified.

*2 AC for 1 minute, R.H.= 40 ~ 60% R.H. In this test, pins 1, 2 are shorted together, and pins 3, 4 are shorted together.

*3 For 10 seconds

Electro-Optical Characteristics (T_A=25°C unless specified otherwise)

Input

Parameter	Symbol	Min.	Typ.	Max.	Unit	Condition
Forward voltage	V _F	-	1.3	1.7	V	I _F = 1mA
Reverse current	I _R	-	-	10	μA	V _R = 5V
Input capacitance	C _{in}	-	30	250	pF	V = 0, f = 1kHz

Output

Parameter	Symbol	Min	Typ.	Max.	Unit	Condition
Collector-Emitter dark current	I _{CEO}	-	-	100	nA	V _{CE} = 20V, I _F = 0mA
Collector-Emitter breakdown voltage	BV _{CEO}	60	-	-	V	I _C = 0.1mA
Emitter-Collector breakdown voltage	BV _{ECO}	5	-	-	V	I _E = 0.1mA

Transfer Characteristics (T_A=25°C unless specified otherwise)

Parameter	Symbo	Min	Typ.	Max.	Unit	Condition
Current Transfer ratio	EL3H7U	50	-	600	%	I _F = 0.5mA, V _{CE} = 5V
	EL3H7UA	100	-	200	%	
	EL3H7UB	150	-	300	%	
	EL3H7UC	200	-	400	%	
Collector-Emitter saturation voltage	V _{CE(sat)}	-	-	0.4	V	I _F = 3mA, I _C = 1.6mA
Isolation resistance	R _{IO}	5×10 ¹⁰	-	-	Ω	V _{IO} = 500Vdc, 40~60% R.H.
Floating capacitance	C _{IO}	-	0.3	1.0	pF	V _{IO} = 0, f = 1MHz
Rise time	t _r	-	8	-	μs	V _{CE} = 2V, I _C = 2mA,
Fall time	t _f	-	10	-	μs	R _L = 100Ω

* Typical values at T_A = 25°C

Typical Electro-Optical Characteristics Curves*

Figure 1. Forward Current vs Forward Voltage

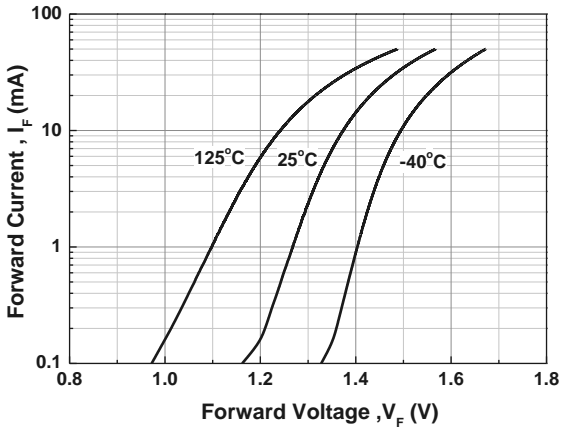

Figure 2. Collector Current vs Forward Current

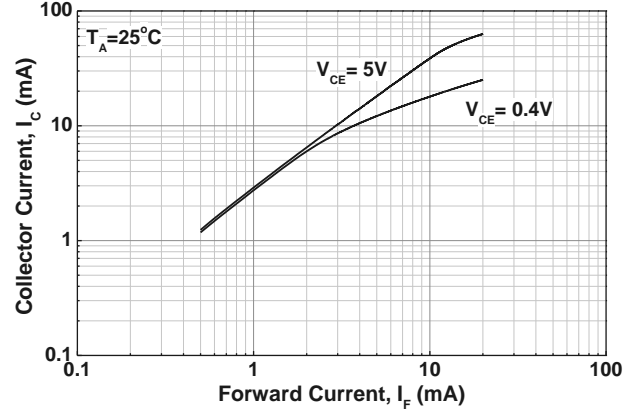

Figure 3. Normalized Current Transfer Ratio vs Forward Current

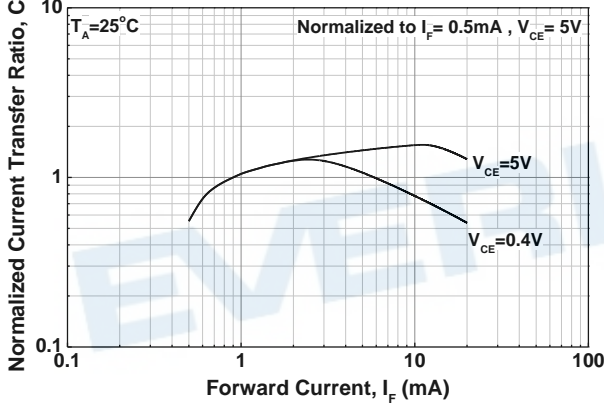

Figure 4. Collector Current vs Collector-Emitter Voltage

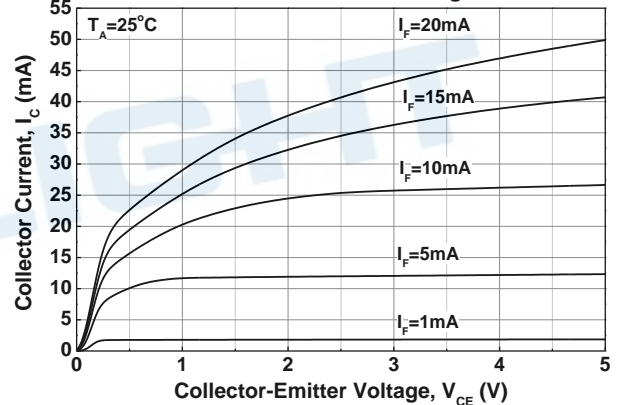

Figure 5. Collector Current vs Collector-Emitter Voltage

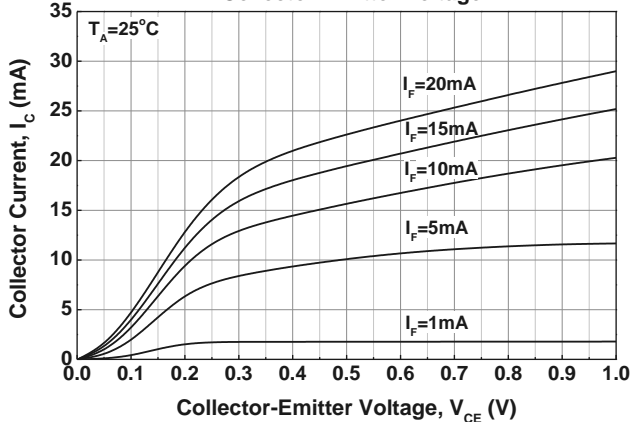
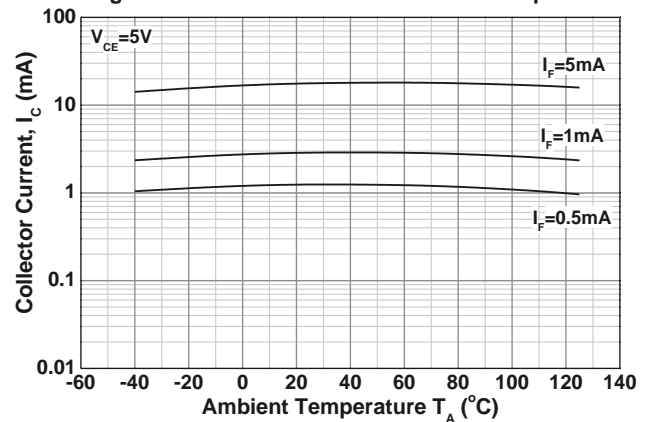
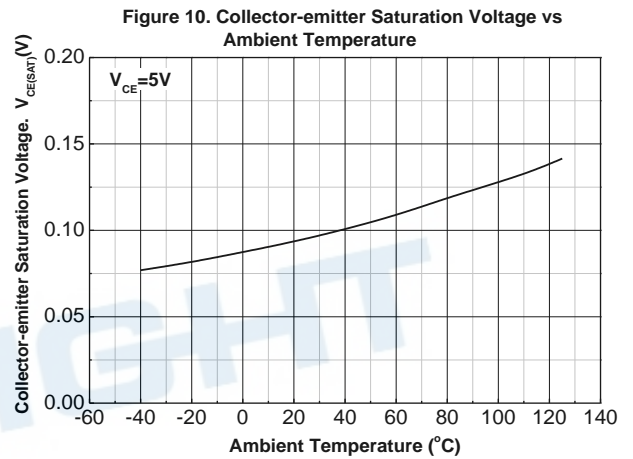
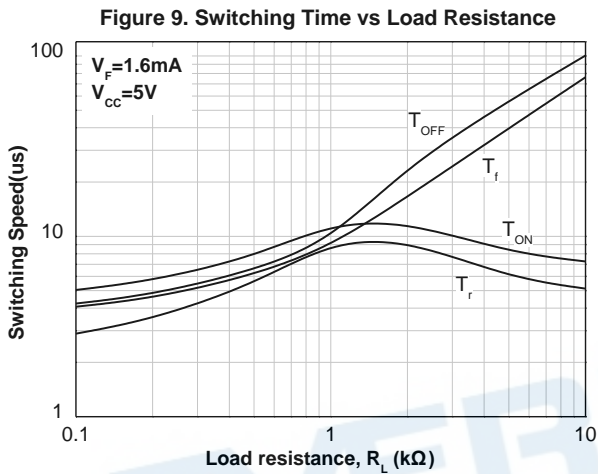
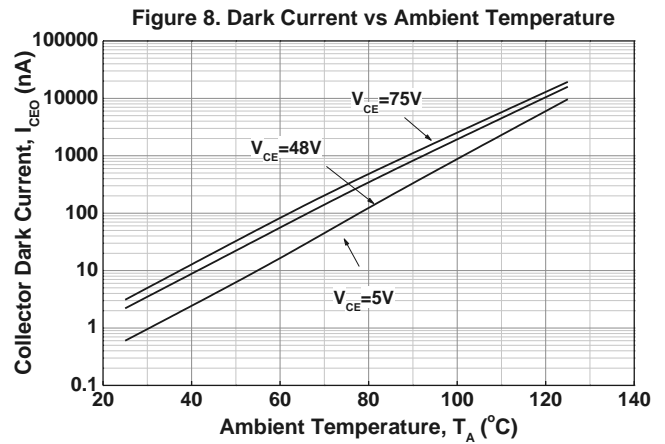
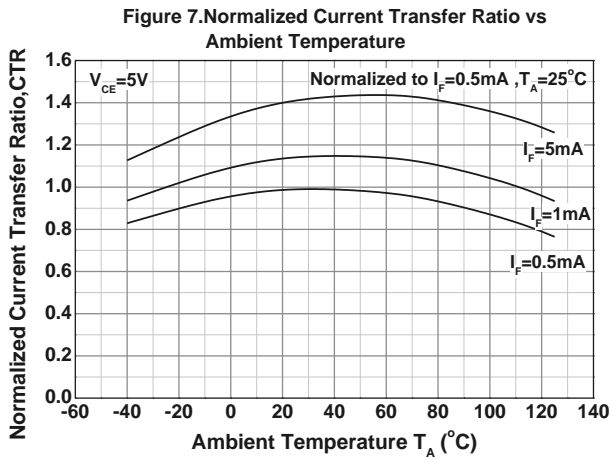

Figure 6. Collector Current vs Ambient Temperature





*Please be aware that all datas in the graph are just for reference and not for guaranteed by production test.

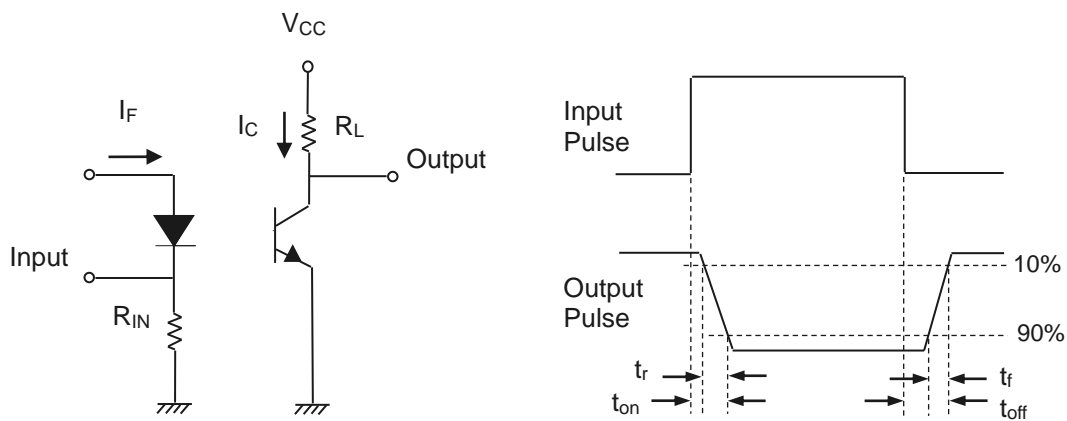

Figure 13. Switching Time Test Circuit & Waveforms

Order Information

Part Number

EL3H7U(X)(Y)-VG

Note

- X = CTR Rank (A, B, C or none)
- Y = Tape and reel option (TA, TB or none)
- V = VDE (optional)
- G = Halogens free

Option	Description	Packing quantity
(TA)	TA Tape & reel option	5000 units per reel
(TB)	TB Tape & reel option	5000 units per reel
(TA)-V	TA Tape & reel option + VDE	5000 units per reel
(TB)-V	TB Tape & reel option + VDE	5000 units per reel

Package Dimension (Dimensions in mm)

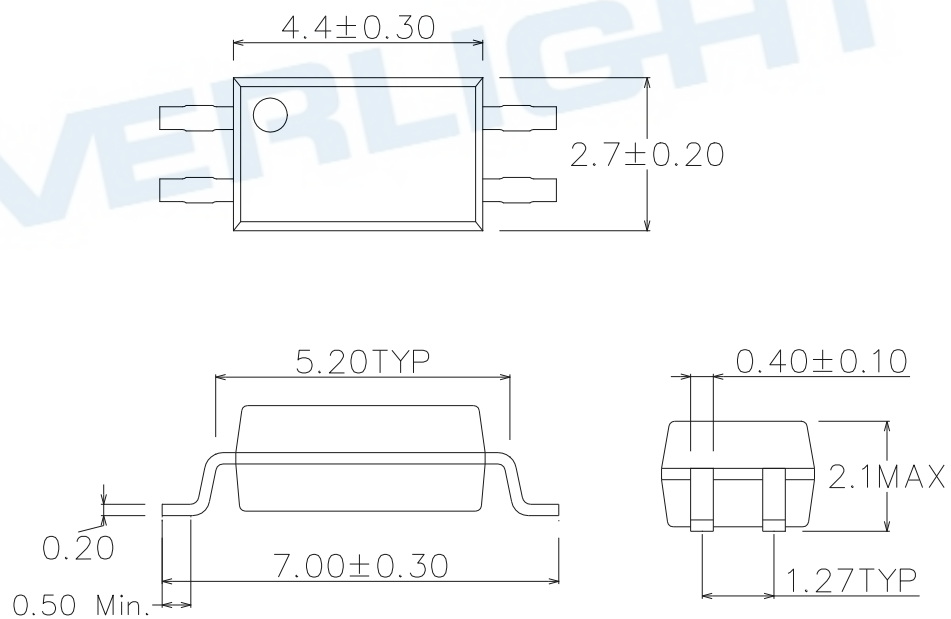

Recommended pad layout for surface mount leadform

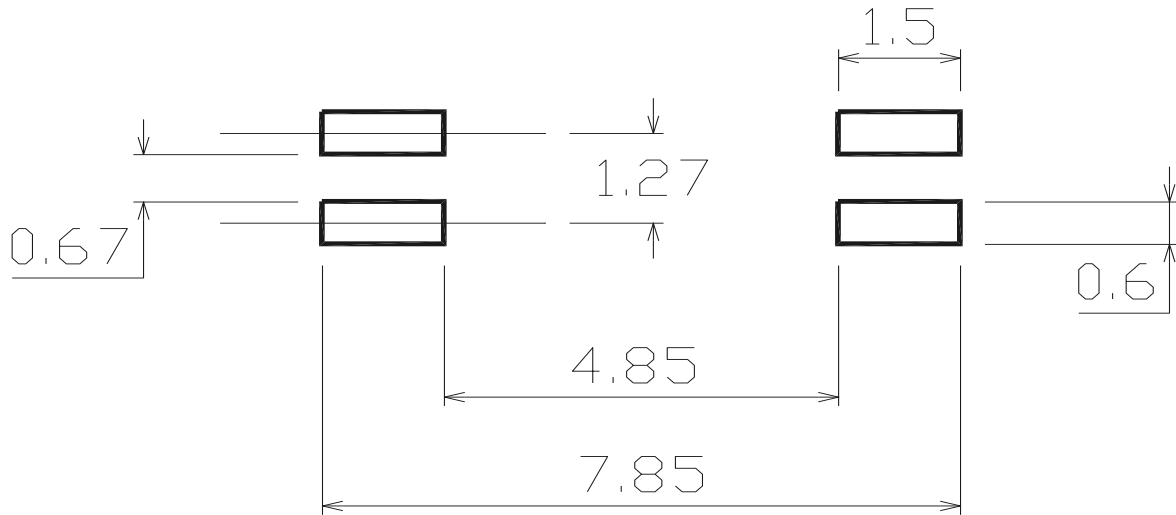

Device Marking

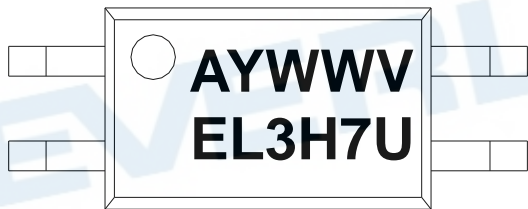

Notes

- EL denotes Everlight
- 3H7U denotes Device Number
- A denotes CTR Rank
- Y denotes 1 digit Year code
- WW denotes 2 digit Week code
- V denotes VDE (optional)

Tape & Reel Packing Specifications

Option TA

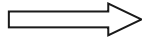
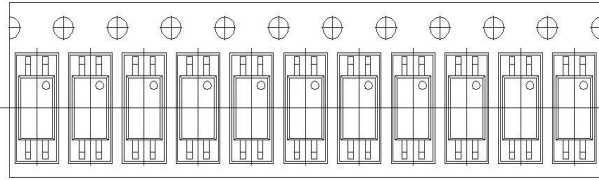

Direction of feed from reel

Option TB

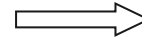
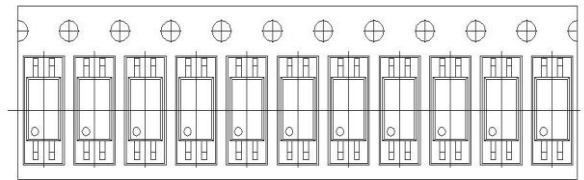

Direction of feed from reel

Tape dimensions

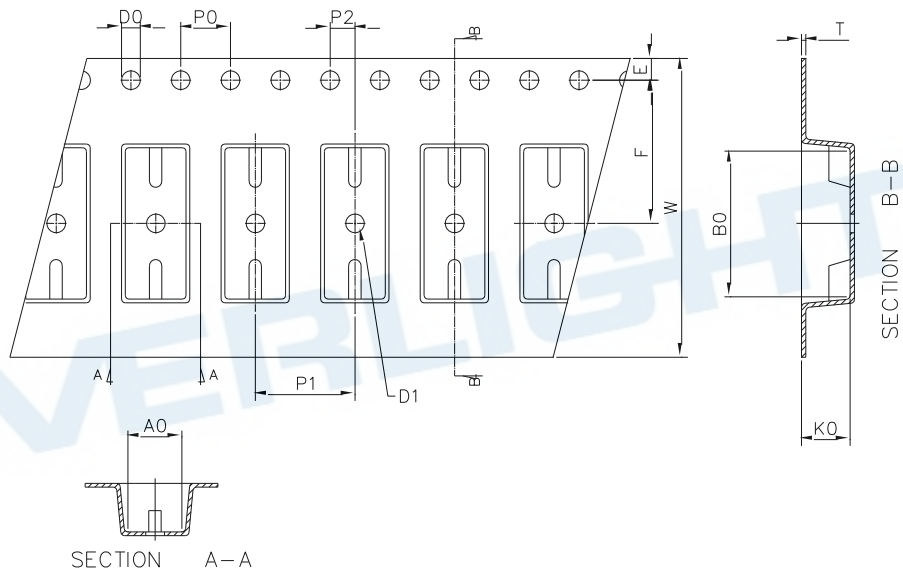

Dimension No.	A0	B0	D0	D1	E	F
Dimension (mm)	3.00 ± 0.10	7.45 ± 0.10	1.50 + 0.1/-0	1.50 ± 0.10	1.75 ± 0.10	5.50 ± 0.10
Dimension No.	P0	P1	P2	t	W	K0
Dimension (mm)	4.00 ± 0.15	8.00 ± 0.10	2.00 ± 0.10	0.30 ± 0.05	12.1 ± 0.2	2.45 ± 0.1

Precautions for Use

1. Soldering Condition

1.1 (A) Maximum Body Case Temperature Profile for evaluation of Reflow Profile

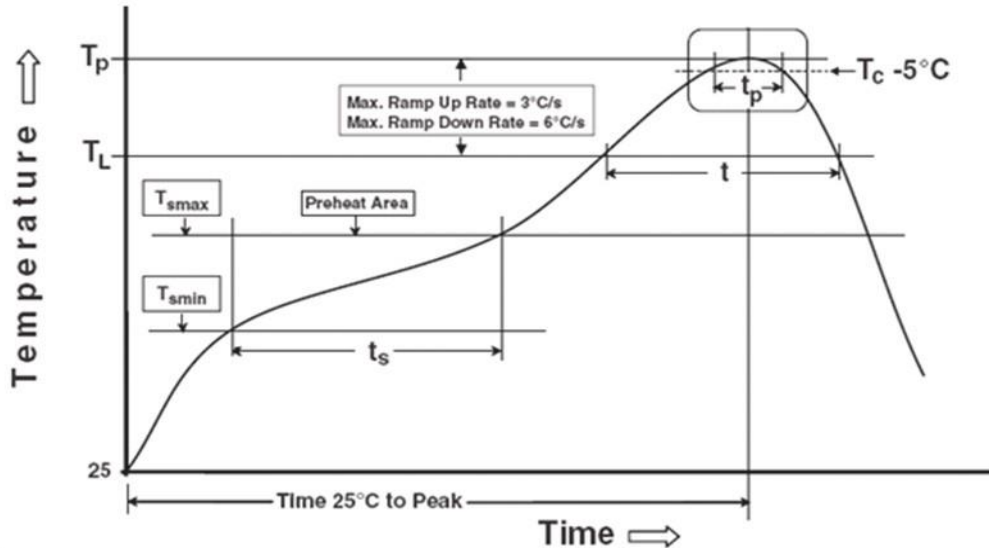

Note:

Reference: IPC/JEDEC J-STD-020D

Preheat

Temperature min (T_{smin})	150 °C
Temperature max (T_{smax})	200°C
Time (T_{smin} to T_{smax}) (t_s)	60-120 seconds
Average ramp-up rate (T_{smax} to T_p)	3 °C/second max

Other

Liquidus Temperature (T_L)	217 °C
Time above Liquidus Temperature (t_L)	60-100 sec
Peak Temperature (T_p)	260°C
Time within 5 °C of Actual Peak Temperature: $T_p - 5^\circ\text{C}$	30 s
Ramp- Down Rate from Peak Temperature	6°C /second max.
Time 25°C to peak temperature	8 minutes max.
Reflow times	3 times

DISCLAIMER

1. Above specification may be changed without notice. EVERLIGHT will reserve authority on material change for above specification.
2. The graphs shown in this datasheet are representing typical data only and do not show guaranteed values.
3. When using this product, please observe the absolute maximum ratings and the instructions for use outlined in these specification sheets. EVERLIGHT assumes no responsibility for any damage resulting from use of the product which does not comply with the absolute maximum ratings and the instructions included in these specification sheets.
4. These specification sheets include materials protected under copyright of EVERLIGHT. Reproduction in any form is prohibited without the specific consent of EVERLIGHT.
5. This product is not intended to be used for military, aircraft, automotive, medical, life sustaining or life saving applications or any other application which can result in human injury or death. Please contact authorized Everlight sales agent for special application request.
6. Statements regarding the suitability of products for certain types of applications are based on Everlight's knowledge of typical requirements that are often placed on Everlight products in generic applications. Such statements are not binding statements about the suitability of products for a particular application. It is the customer's responsibility to validate that a particular product with the properties described in the product specification is suitable for use in a particular application. Parameters provided in datasheets and/or specifications may vary in different applications and performance may vary over time. All operating parameters, including typical parameters, must be validated for each customer application by the customer's technical experts. Product specifications do not expand or otherwise modify Everlight's terms and conditions of purchase, including but not limited to the warranty expressed therein.